

LEGEND / FINISHES SCHEDULE

	EXISTING RL EXISTING TREE TO BE REMOVED NOTE: All noxious weeds on the site shall be removed and destroyed as per their classification under the noxious weeds Act. EXISTING TREE TO BE RETAINED AND SHALL BE PROTECTED DURING CONSTRUCTION IN ACCORDANCE WITH AS 4970:2009 TREE PRUNING SHALL BE IN ACCORDANCE WITH AS 4373 EXISTING TREE NO. (REFER TO ARBORIST REPORT) STRUCTURAL ROOT ZONE TO ARBORIST DETAIL TREE PROTECTION ZONE TO ARBORIST DETAIL PROPOSED TREES, SHRUBS & GROUND COVER (REFER NO. TO PLANT SCHEDULE) TREE STOCK FOR LANDSCAPE USE SHALL BE IN ACCORDANCE WITH AS 2303 BOUNDARY FENCE MULCHED GARDEN BED 900 WIDE MIN OR AS SHOWN ON PLAN REFER TO DETAIL 1 & 2 SELECTED METAL GARDEN EDGE OR AS SELECTED REFER TO DETAIL 1 SELECTED RETAINING WALL / OSD WALL ALL RETAINING WALL HEIGHT SHALL BE CONFIRM ON SITE AND TO -TO ENGINEER DETAIL & TO BCA REQUIREMENTS 100 HIGH HOB TO ENGINEER/ARCH. DETAIL (REFER TO DETAIL 3-TYPICAL) 1800 HIGH TRELLIS ALONG FENCE SELECTED WIRE TRELLIS LAWN AREA SIR WALTER BUFFALO REFER TO DETAIL 1 All turf area shall be finished level with adjoining surfaces and also fall evenly to approved point of drainage discharge. PERMEABLE PEBBLE AREA SELECTED 100 DEPTH RIVER PEBBLES WITH WEED MAT UNDER COMMON OPEN SPACE SELECTED TILES - TO AUST. STANDARDS PATIO / TERRACE / PATH SELECTED TILES - TO AUST. STANDARDS SELECTED CONC. STEPPING STONES SET WITHIN MULCHED AREA SELECTED LETTER BOX -TO AUST POST REQUIREMENTS AND TO AS/NZS 4253:1994 SELECTED ILLUMINATION ILLUMINATION SHALL BE DESIGNED BY A QUALIFIED LIGHTING CONSULTANT AND WITH AS 4282, AS 1680 & AS 1158 IN ACCORDANCE NOTE: ENSURE NO ADVERSE IMPACT ON THE ADJACENT OF THE SURROUNDING AREA BY LIGHT OVERSPILL DRAINAGE REFER TO ENGINEER PLANS FOR DETAILS NOTE: PROVIDE SELECTED HEEL GUARD GRATES TO FITS ON TRAFFICABLE AREAS - TO MANUF. DETAIL DRAINAGE GRATE DRAINAGE PIT
--	--

ITEM	MATERIAL
SOIL DETAIL 1 & 2	NOTE: ALL SOIL TYPE AS PER AUST. NATIVE LANDSCAPE SUPPLY OR EQUIVALENT AND SHALL BE IN ACCORDANCE WITH AS 4419 AND AS 4454 FOR SOIL CONDITIONERS AND COMPOSTS
LAWN AREA	1st QUALITY TOP SOIL
NATIVE GARDEN BED	NATIVE GARDEN MIX
EXOTIC GARDEN BED	ORGANIC GARDEN MIX
PLANTER BOX 	PLANTER BOX MIX IN ACCORDANCE WITH AS4149:1998 & AS3743 BENEDICT SMARTMIX LIGHTWEIGHT PLANTER BOX MIX OR SIMILAR NOTE: PLANTER BOX OVER PODIUM SLABS SHALL PROVIDE ADEQUATE SOIL VOLUME SHOWN TO ALLOW FOR HEALTHY TREE GROWTH
MULCH	SELECTED HARD WOOD CHIP SHALL BE IN ACCORDANCE WITH AS 4454
PLANT MATERIAL	AS PER PLANT SCHEDULE REFER TO DETAIL 2
GARDEN EDGE	SELECTED METAL EDGING OR AS SELECTED REFER TO DETAIL 1
FENCE SIDES & REAR BOUNDARY 	1800 HIGH LAPPED & CAPPED TIMBER FENCE OR 1800 HIGH COLOURBOND UNLESS THE TYPE OF MATERIAL IS STIPULATED IN ANY ACOUSTIC REPORT AND FLOOD STUDY PREPARE FOR THE SITE
IRRIGATION	PROVIDE DRIP IRRIGATION SYSTEM TO ALL PLANTER BOXES IN ACCORDANCE WITH AS3500 AND SYDNEY WATER CODE IRRIGATION SHALL BE DESIGNED & INSTALLED BY QUALIFIED IRRIGATION CONTRACTORS
GRC PLANTERS 	Satu Bumi or SIMILAR https://satubumi.com.au/ Cube 1000x1000 1000 L x 1000 W x 1000 H Tall Rectangle 800 2200 L x 1000 W x 800 H Rectangle 600 2400 L x 600 W x 600 H Rectangle 600 1800 L x 600 W x 600 H Rectangle 600 1200 L x 600 W x 600 H

LANDSCAPE PLAN

PROPOSED RESIDENTIAL DEVELOPMENT
(s4.55 Application)

DRAWING SCHEDULE

DRAWING NO:	DRAWING TITLE
24008 s4.551 -5	LEGEND / DETAILS / PLANT SCHEDULE
24008 s4.552 -5	GROUND LEVEL LANDSCAPE LAYOUT PLAN
24008 s4.553 -5	GROUND LEVEL LANDSCAPE LAYOUT PLAN
24008 s4.554 -5	GROUND LEVEL LANDSCAPE PLANTING PLAN
24008 s4.555 -5	GROUND LEVEL LANDSCAPE PLANTING PLAN

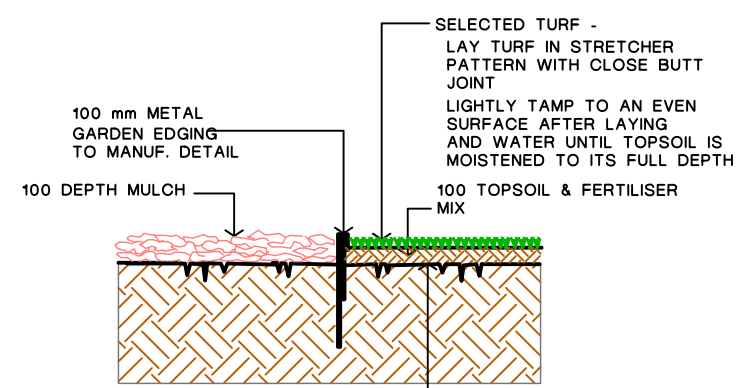
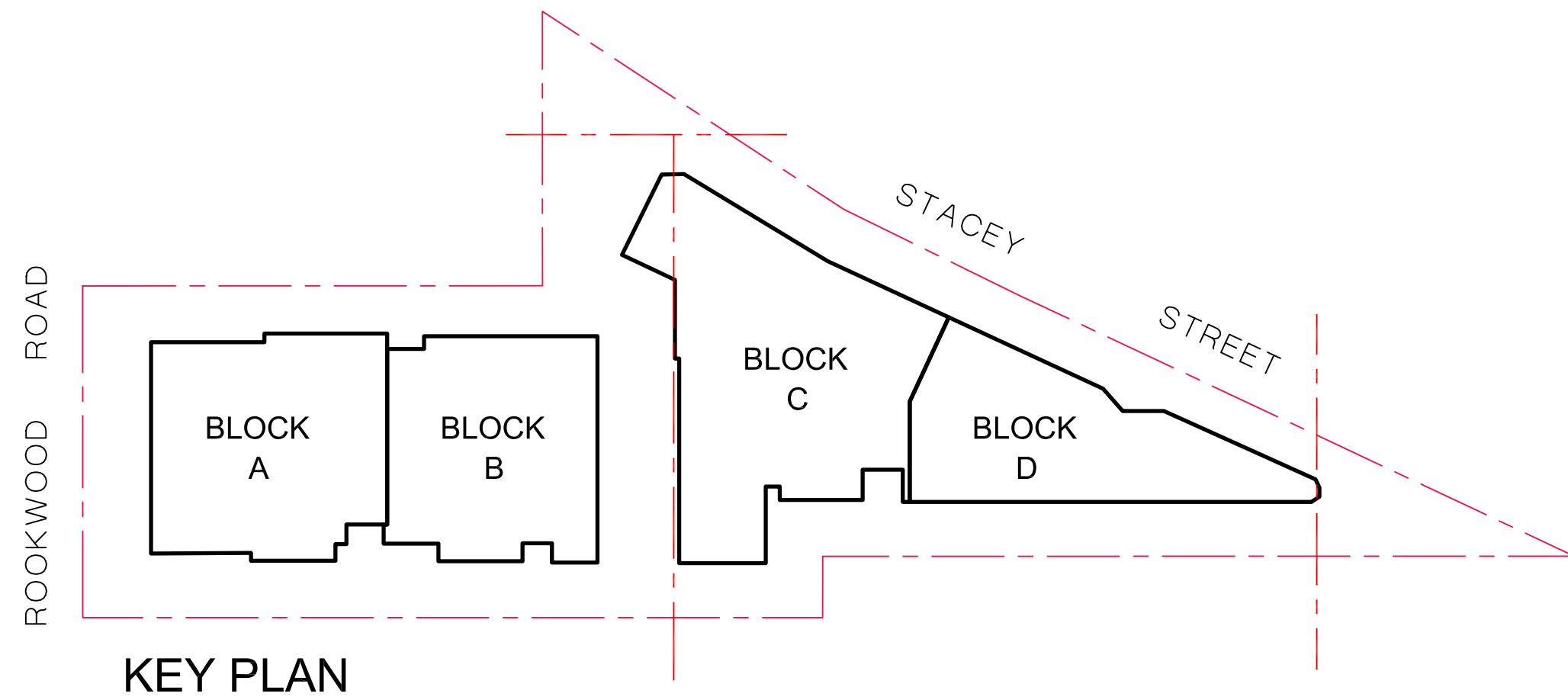

1. TURF & METAL GARDEN EDGE DETAIL

NOTE:
ALIGNMENT OF METAL EDGE SHALL BE EVEN & FREE FROM DIPS AND HUMPS.
ALL TURFED AREAS SHALL BE FINISHED LEVEL WITH ADJOINING SURFACES AND ALSO FALL EVENLY TO APPROVED POINTS OF DRAINAGE DISCHARGE

SELECTED PLANTING
THOROUGHLY WATER PLANT BEFORE & AFTER PLANTING
80 WIDE WEBBING TIE CROSSED TO FORM A FIGURE 8 AND STAPLED TO STAKE
MOUNDED WATER BASIN

STAKE SIZE QUANTITY PLANT
2400x60x60 3 >2500 (4SL POT)
1800x60x60 2 1-2500 (2SL POT)
1200x36x36 1 <1000 (1SL POT)

BACKFILL WITH SELECTED GARDEN MIXTURE - COMPACTED LIGHTLY & UNIFORMLY IN 100 LAYERS
ALL PLANTING SHALL USE WATER CRYSTALS EXPANDED IN WATER BEFORE PLANTING

MOIST ROOTBALL
SUB-GRADE BROKEN UP TO 100 DEPTH
SHAPE SUB-SOIL TO FALL TO SUB-SOIL DRAINS
NOTE:
CLAY SOIL SHALL BE IMPROVED BY ADDING GYPSUM AS PER MANUF. SPEC

NOTE:
DO NOT PLANT IN UNSUITABLE WEATHER CONDITIONS SUCH AS EXTREME HEAT, COLD, WIND OR RAIN
CLAY SOIL IS TO BE TREATED WITH CLAY BREAKER AND ORGANIC COMPOST

ALL SOIL TYPE AS PER AUST. NATIVE LANDSCAPE SUPPLY OR EQUIVALENT AND SHALL BE IN ACCORDANCE WITH AS 4419

NOTE:
DO NOT PLANT IN UNSUITABLE WEATHER CONDITIONS SUCH AS EXTREME HEAT, COLD, WIND OR RAIN
CLAY SOIL IS TO BE TREATED WITH CLAY BREAKER AND ORGANIC COMPOST

ALL SOIL TYPE AS PER AUST. NATIVE LANDSCAPE SUPPLY OR EQUIVALENT AND SHALL BE IN ACCORDANCE WITH AS 4419

ALL SOIL TYPE AS PER AUST. NATIVE LANDSCAPE SUPPLY OR EQUIVALENT AND SHALL BE IN ACCORDANCE WITH AS 4419

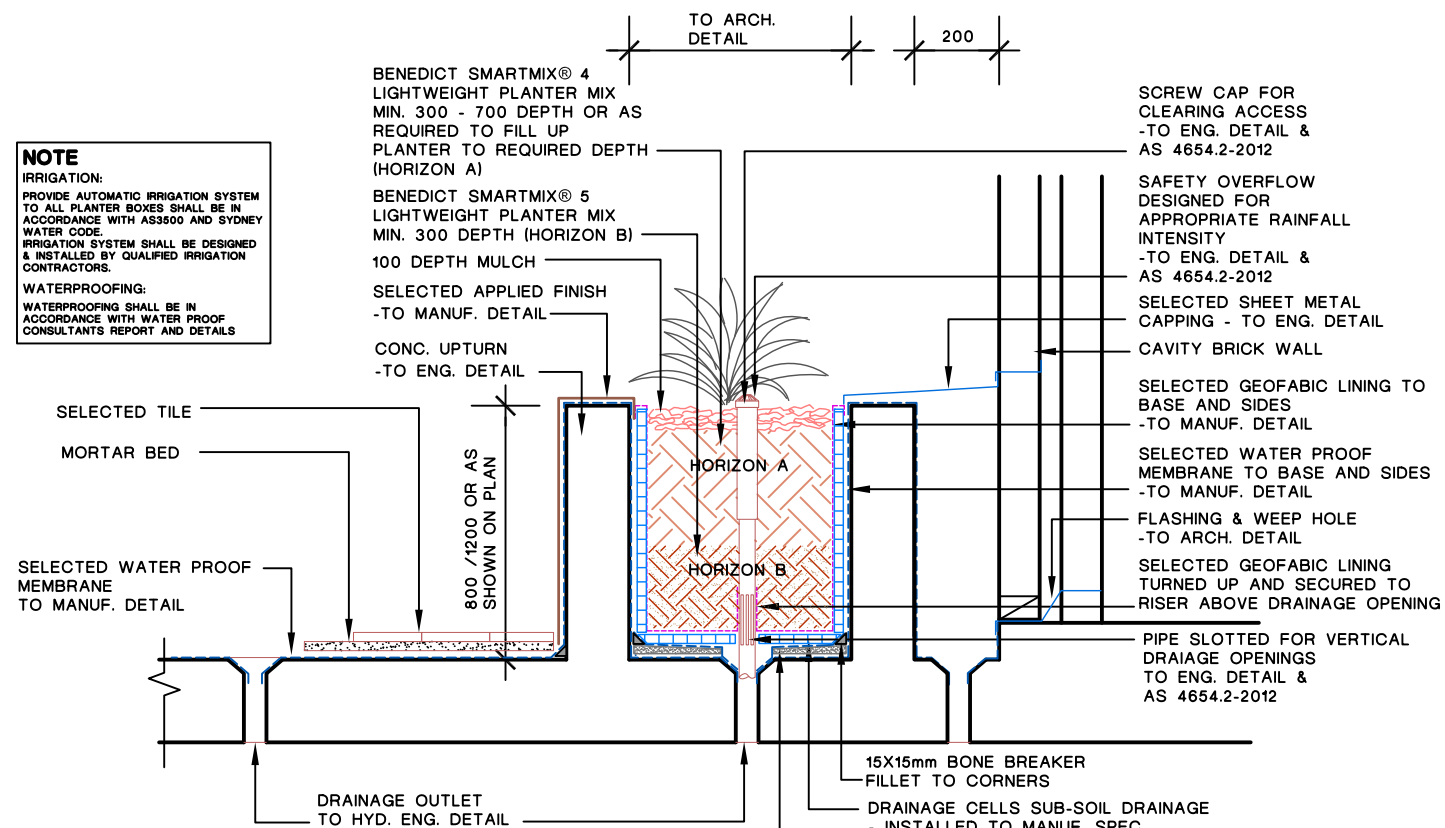
3. TERRACE / AGAINST BUILDING WALL
PLANTER BOX DETAIL

NOTE:
THE TREES SHALL COMPLY WITH NATSPEC SPECIFYING TREES:
A GUIDE TO ASSESSMENT OF TREE QUALITY (2003) OR AUSTRALIAN STANDARD AS 2303
- 2015 TREE STOCK FOR LANDSCAPE USE
HEIGHT AND SPAN ARE INDICATIVE ONLY SUBJECT TO ON SITE ENVIRONMENTAL FACTORS.
USE ONLY AS A GUIDE.

PROPOSED PLANT SCHEDULE IN ACCORDANCE WITH AS 2303: 2015						
CODE	BOTANICAL NAME	COMMON NAME	APPROX MATURED HEIGHT	POT SIZE	QUANTITY	
GROUND COVER / BOARDER						
1	Agapanthus orientalis 'Blue'	Blue Lily of the Nile	0.5M	200mm	80	
1a	Hardenbergia violacea	Native sarsaparilla	2.0M	200mm	144	
2	Lomandra 'Tanika'	Dwarf Mat Rush	0.4M	150mm	114	
2a	Pandorea jasminoides	Bower Plant	2.5M	200mm	12	
3	Dichondra repens	Kidney weed	0.1M	tubes	5	
3a	Pandorea pandorana	Wonga Wonga Vine	3.0M	200mm	32	
4	Liriope Evergreen Giant	Turf Lily	0.4M	150mm	68	
5	Dianella caerulea	Blue Flax Lily	0.4M	100mm	198	
5a	Dichondra Silver Falls	Silver Falls	0.1	150mm	74	
6	Viola hederacea	Native Violets	0.1M	tubes	219	
7	Clivia miniata	Kaffir Lily	0.5M	200mm	67	
8	Crinum pedunculatum	Swamp Lily	0.5-0.7	200mm	99	
9	Trachelospermum tricolor	Var. Star Jasmine	0.5M	200mm	6	
LOW SHRUBS						
11	Buxus microphylla 'Japonica'	Japanese Box Hedge	0.4-1.2M	200mm	13	
13	Philodendron Xanadu	Xanadu	0.7	200mm	115	
14	Pittosporum tobira 'Miss Muffet'	Miss Muffet Pittosporum	0.8-1.0M	200mm	52	
16	Murraya paniculata	Orange Jessamine	2-3.0M	300mm	70	
TALL SHRUBS						
21	Callistemon SLIM	Slim callistemon	3		35	
22	Alpinia zerumbet variegata	Variegated Shell Ginger	1.5		84	
23	Camellia japonica 'Emperor Russia'	Camellia japonica	3-4.0M	45L	14	
24	Callistemon 'Little Jet'	Little Jet Bottlebrush	0.8-1.4M	200mm	20	
25	Syzygium 'Resilience'	Resilience Lilly Pilly	2.5-3.5M	300mm	60	
26	Syzygium leuhmanni	Small Leaved Lilly Pilly	4-5.0M	75L	74	
27	Camellia sasanqua 'Selsuekka'	Camellia sasanqua	2-2.5M	300mm	15	
29	Photinia 'Glabra Rubens'	Small Leaved Photinia	1.5-2.0M	300mm	8	
30	Syzygium 'Winter Lights'	Winter Lights Lilly Pilly	1.6-2.8M	200mm	73	
FEATURE SHRUBS						
32	Cyathea australis	Tree Fern	2-4.0M	300mm	17	
33	Yucca elaphantipes	Giant Yucca	1.5M	300mm	1	
34	Phormium tenax 'Purpureum'	Purple Flax	0.8-1.2M	200mm	41	
35	Alcanatarea 'Rubra'	Giant Bromeliad	1.0M	300mm	24	
36	Strelitzia reginae 'Dwarf'	Dwarf Bird of Paradise	0.7M	200mm	2	
37	Strelitzia reginae	Bird of Paradise	1-1.2M	250mm	31	
38	Dracaena draco	Dragon Tree	2.5-3.5M	semi adv	1	
39	Textilia gracilis	Slender Weavers	6-8.0M	300mm	22	
40	Archontophoenix cunninghamiana	Bangalow Palm	8-12M	Semi adv	16	
TREES						
41	Acer platanoides 'Crimson Sentry'	Crimson Maple	5-7.0M	100L	1	
42	Pyrus ussuriensis	Manchurian Pear	9-12.0M	75L	1	
43	Elaeocarpus reticulatus	Blueberry Ash	6-8.0M	300mm	13	
44	Banksia serrata	Old Man Banksia	4-6.0M	45L	1	
45	Cupanopsis anacardoides	Tuckeroo	5-7.0M	75L	2	
46	Lagerstroemia indica	Crape Myrtle	5-6.0M	45L	2	
47	Livistona australis	Cabbage Palm	8-12.0M	semi adv	1	
48	Magnolia 'Little Gem'	Little Gem	2.5-3.0M	300mm	18	
49	Sapulum sebiferum	Chinese Tallowood	12-15.0M	75L	8	
50	Waterhousia floribundum	Weeping Lilly Pilly	9-13.0M	75L	3	
51	Waterhousia 'Sweeper'	Sweeper Waterhousia	8-10.0M	100L	10	
52	Banksia integrifolia	Coast Banksia	12-15.DM	75L	9	
53	Corymbia maculata	Spotted Gum	15-20.0M	100L	6	
54	Lophostemon confertus	Brushbox	9-13.0M	75L	1	
55	Stenocarpus sinuatus	Fire wheel Tree	15-20.0M	75L	2	

REV	DESCRIPTION	REVISION DATE
F	S4.55 ISSUE	14.4.25
E	ISSUE FOR CONSTRUCTION	18/9/24
D	AMEND U49 PLANTER BOX AS REQ BY PASCADEN	15/7/24
C	ADDED STEPPING STONES FOR FIRE ESCAPE & ADD RAMP & STEPS OVER OSD	5/6/24
B	REMOVED SHADE SAIL	21/5/24
A	CC ISSUE	11/3/24

NOTE:

- In the event of anY inconsistency between the architectural plans and stormwater plans, The architectural plan shall prevail to the extent of the inconsistency
- All landscape works shall be carried out by members of the LANDSCAPE CONTRACTORS ASSOCIATION of AUSTRALIA.
- Contractors must verify all dimensions at the site before commencing any work or making any shop drawings which must be approved before manufacturing.
- Do not scale drawing, if in doubt - ASK
- This drawing is to be read in conjunction with Architectural, Hydraulic and survey plans
- All Existing trees to remain shall be protected as per arborist report & council requirements
- All pruning shall be in accordance with the AS 4373
- Thoroughly eradicate weeds from all garden areas.
- No variation to the works to be carried out without prior approval from owner.
- All materials to be the best of their respective kinds and shall comply with approved sample type submitted or specified.
- Substitution of plant species or varieties will not be permitted.
- Unless otherwise specified or directed, all instructions are to be issued by the consulting landscape designer.
- All storm water outlets & surface run off shall be to Hydraulic Engineers detail.
- Provide sub-soil drainage to garden beds & lawn areas where required - To be confirmed on site.
- Refer to survey plan for position of all existing services.
- Refer to Architectural elevations & Sections for existing and proposed ground lines.
- All landscape works shall comply with all councils DA & CC conditions and all relevant "AUSTRALIAN STANDARDS" and AUS SPEC NO.1 Specification C273-Landscaping.
- Irrigation system - If required, shall be designed & installed to comply with AS 2698, AS 2698.1-1994, AS 2698.2-1985, AS 2698.3-1990, water board and other relevant authority regulations.
- Landscaping is to be installed in accordance with the approved landscape plan.
All works and methods nominated and materials and plants specified on the approved landscape plan are to be completed prior to the issue of an occupation certificate. The landscaping shall be maintained for the life of the development.

Maintenance

- All landscape works are to be maintained for a period of 12 months (or as required by council DA Consent) by landscape contractor after final completion AND shall be maintained at all times in a suitable manner. Replace all plants which have failed with the same species. Mulch is to be maintained at specified depth. All plants and turf shall be watered on a regular basis to maintain moisture levels required for optimum growth. All garden areas are to be maintained free from weeds.

For Construction

PROPOSED RESIDENTIAL DEVELOPMENT

25-29 Rookwood Road,
Yagoona

ARCHITECT:

zhinarchitects

vision dynamics
landscape design
pty ltd.
m: 0412 282 888
Ph: (02) 9499 8888
em : visiondynamics @ westnet.com.au

DRAWING TITLE

LEGEND / DETAILS /
PLANT SCHEDULE

DRAWN FF SCALE 1:100@A1 OR 1:200@A3 REV. F

DRAWING NUMBER 24008 s4.55 1-5

Landscaping Design Institute
Professional Member

NORTH